

### FEATURES

- LOW Cost,High Quality
- Compact Size,Light Weight
- High Performance
- Wide Operation Temperature Range
- Octave and Multi-octave Bands

### APPLICATIONS

- Load isolation
- Module integration



### ELECTRICAL SPECIFICATIONS@25°C:

Parameter	Min	Typical	Max	Units
Frequency Range	7.8		8.4	GHz
Band Width		600		MHz
Insertion Loss			0.4	dB
Isolation	23			dB
VSWR			1.25	Ratio
Power Handling(average)			350	Watt

### ENVIRONMENTAL RATINGS:

Parameter	Min	Typical	Max	Units
Operating Temperature	-40		+85	°C
Non-operating Temperature	-40		85	°C
Relative humidity (non-condensing)		95		%
Altitude (MIL-STD-810F)	10000		30000	Feet
Shock / Vibration (MIL-STD-810F)		Airbone		
ROHS		Compliant		

### MECHANICAL SPECIFICATIONS:

Parameter	Value	Limits	Units
Dimensions(L*W*H)	60*65*47.8	Max	Milimeter
Weight	100	Max	gram
RF Connectors Input	SMA-F		
RF Connectors output	SMA-F		
Impedance	50		Ohms

**Other frequency bands&specifications are also available**

### OUTLINE DRAWING(mm):

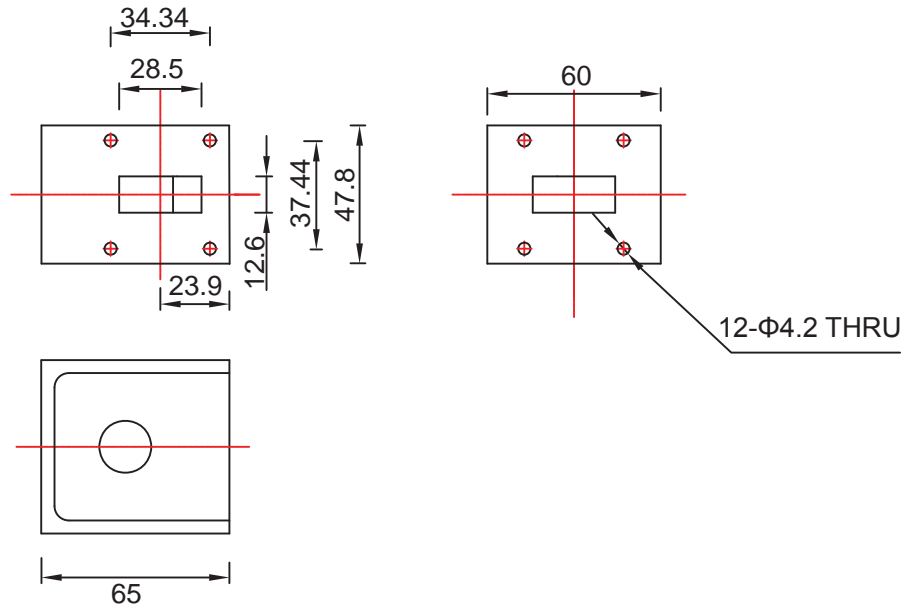

WR02