

FEATURES

- DC-40GHz, up to 50kW
- High Reliability, Repeatable Performance
- Anti-pulse and Anti-burnout
- Low IM3 Versions Available

APPLICATIONS

- Military & Space
- Radar&Electronic warfare
- Test Equipment

ELECTRICAL SPECIFICATIONS@25°C:

Frequency Range(GHz)	Max VSWR
DC-3	1.10
DC-6	1.20
DC-8	1.25
DC-10	1.35
DC-18	1.55

MECHANICAL SPECIFICATIONS:

Parameter	Value	Limits	Units
Dimensions	68*51*27;90*51*27*(DC-18G)		millimeter
Weight	135;190(DC-18)	type	gram
Operating Temperature	-55~+125		°C
Impedance	50		ohms

OUTLINE DRAWING(mm):

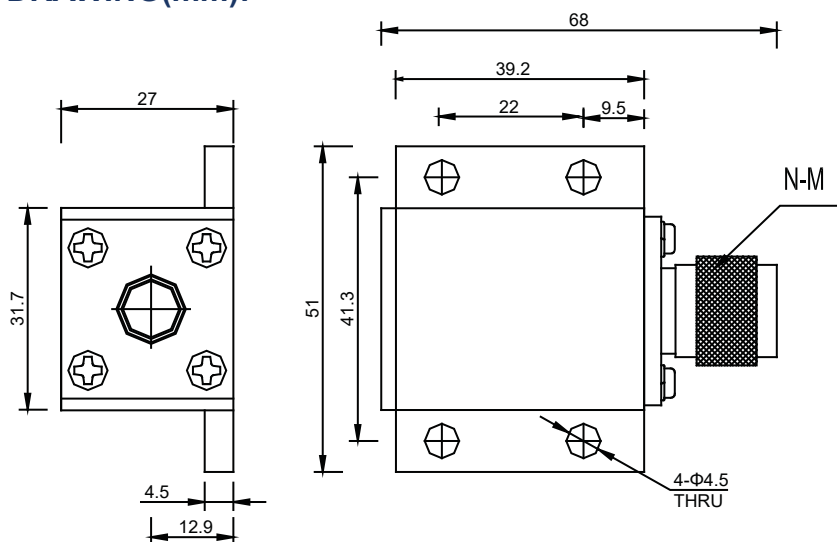

Note:

- 1.Average power:50W @ 25°C , 5W @ 125°C.
- 2.Peak power: 10KW (5μs pulse width with 0.5% duty cycle).
- 6.Connector type: N,SMA, please remark connector type when order standard part is N-M .
- 7.Customized specification is also available.