

FEATURES

- DC-40GHz, up to 50kW
- High Reliability, Repeatable Performance
- Anti-pulse and Anti-burnout
- Low IM3 Versions Available

APPLICATIONS

- Military & Space
- Radar&Electronic warfare
- Test Equipment

ELECTRICAL SPECIFICATIONS@25°C:

Part Number	Frequency Range(GHz)	Max VSWR
MCT030H050M	DC - 3	1.25
MCT060H050M	3 - 6	1.35

MECHANICAL SPECIFICATIONS:

Parameter	Value	Limits	Units
Dimensions	34.8*38*17.6		millimeter
Weight	26	type	gram
Operating Temperature	-55~+125		°C
Impedance	50		ohms

OUTLINE DRAWING(mm):

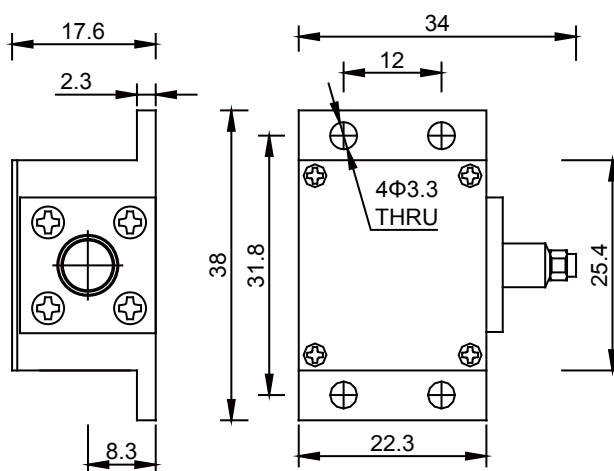

Note:

- 1.Average power:50W @ 25°C , 5W @ 125°C.
- 2.Peak power: 1KW (5μs pulse width with 3% duty cycle).
- 6.Connector type: SMA(F) male or female, please remark connector type when order standard part is SMA-F .
- 7.Customized specification is also available.