

FEATURES

- DC-40GHz, up to 50kW
- High Reliability, Repeatable Performance
- Anti-pulse and Anti-burnout
- Low IM3 Versions Available

APPLICATIONS

- Military & Space
- Radar&Electronic warfare
- Test Equipment

ELECTRICAL SPECIFICATIONS@25°C:

Model Numbe	Frequency Range(GHz)	Max VSWR
MCT030H100M	DC-3	1.3

MECHANICAL SPECIFICATIONS:

Parameter	Value	Limits	Units
Dimensions	N(F):55×39.8×17.6/N(M):45×39.6×17.6/SMA:36.5×39.6×17.6		millimeter
Weight	N(F):115/N(M):105/SMA:94	type	gram
Operating Temperature	-55~+125		°C
Impedance	50		ohms

OUTLINE DRAWING(mm):

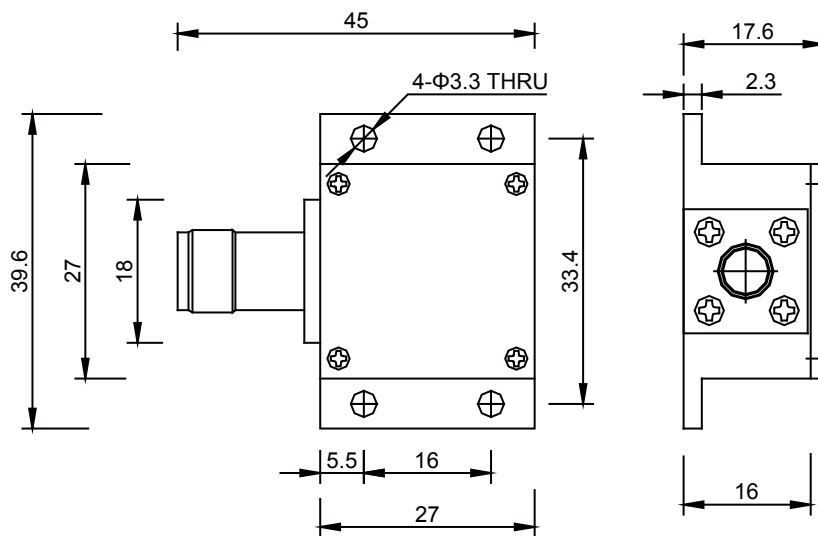

Note:

- 1.Average power:100W @ 25°C, 10W @ 125°C.
- 2.Peak power: 1KW (5μs pulse width with 10% duty cycle).
- 6.Connector type: SMA(M) male or female, please remark connector type when order standard part is SMA-M.
- 7.Customized specification is also available.